

Licensing Act 2003

**PART A – PREMISES LICENCE**

Granted by the London Borough of Enfield as Licensing Authority

Premises Licence Number :

**Part 1 – Premises Details**

Postal address of premises :

Premises name :

Telephone number :

Address :

Where the licence is time-limited, the dates :

The opening hours of the premises, the licensable activities authorised by the licence and the times the licence authorises the carrying out of those activities :

(1) **Open to the Public - Whole Premises**  
Sunday : 11:00 - 00:00  
Monday : 11:00 - 00:00  
Tuesday : 11:00 - 00:00  
Wednesday : 11:00 - 00:00  
Thursday : 11:00 - 00:00  
Friday : 11:00 - 00:00  
Saturday : 11:00 - 00:00

(2) **Supply of Alcohol - On Supplies**  
Sunday : 11:00 - 23:30  
Monday : 11:00 - 23:30  
Tuesday : 11:00 - 23:30  
Wednesday : 11:00 - 23:30  
Thursday : 11:00 - 23:30  
Friday : 11:00 - 23:30  
Saturday : 11:00 - 23:30

## Part 2

Name and (registered) address of holder of premises licence :

Name :	Mr Ajahar Ali
Telephone number :	[REDACTED]
e-mail :	[REDACTED]
Address :	[REDACTED]

Registered number of holder (where applicable) :

Not applicable

Name and (registered) address of second holder of premises licence (where applicable) :

Name :	Not applicable
Telephone number :	
Address :	

Name and address of designated premises supervisor (where the licence authorises the supply of alcohol) :

Name :	[REDACTED]
Telephone number :	[REDACTED]
e-mail :	[REDACTED]
Address :	[REDACTED]

Personal licence number and issuing authority of personal licence held by designated premises supervisor (where the licence authorises the supply of alcohol) :

Personal Licence Number : LN/200600598

Issuing Authority : London Borough of Enfield

Premises Licence LN/200600601 was first granted on 24 November 2006.

Signed :



Date : 17th October 2016

for and on behalf of the  
London Borough of Enfield  
Licensing Unit, Civic Centre, Silver Street, Enfield EN1 3XH  
Telephone : 020 8379 3578

## **Annex 1 - Mandatory conditions**

**The Mandatory Conditions are attached and form part of the Operating Schedule of your licence/certificate. You must ensure that the operation of the licensed premises complies with the attached Mandatory Conditions as well as the Conditions in Annex 2 and Annex 3 (if applicable). Failure to do this can lead to prosecution or review of the licence.**

## **Annex 2 - Conditions consistent with the Operating Schedule**

**1. There shall be no adult entertainment or services, activities or matters ancillary to the use of the premises that may give rise to concern in respect of children.**

**2. Children under the age of 18 shall only be permitted in the premises if it shall be non-smoking throughout or alternatively only in a separate no smoking area of the premises which is physically separated from any smoking areas until such time as legislation is introduced to control smoking in public places, the exception being attendance at private functions e.g. family events such as weddings, birthday parties and for the collection of take-away food.**

**3. Signs shall be conspicuously displayed at all exits requesting patrons to consider local residents and leave the premises and the area quietly.**

## **Annex 3 - Conditions attached after a hearing by the licensing authority**

**Not applicable**

Annex 4 – Plans

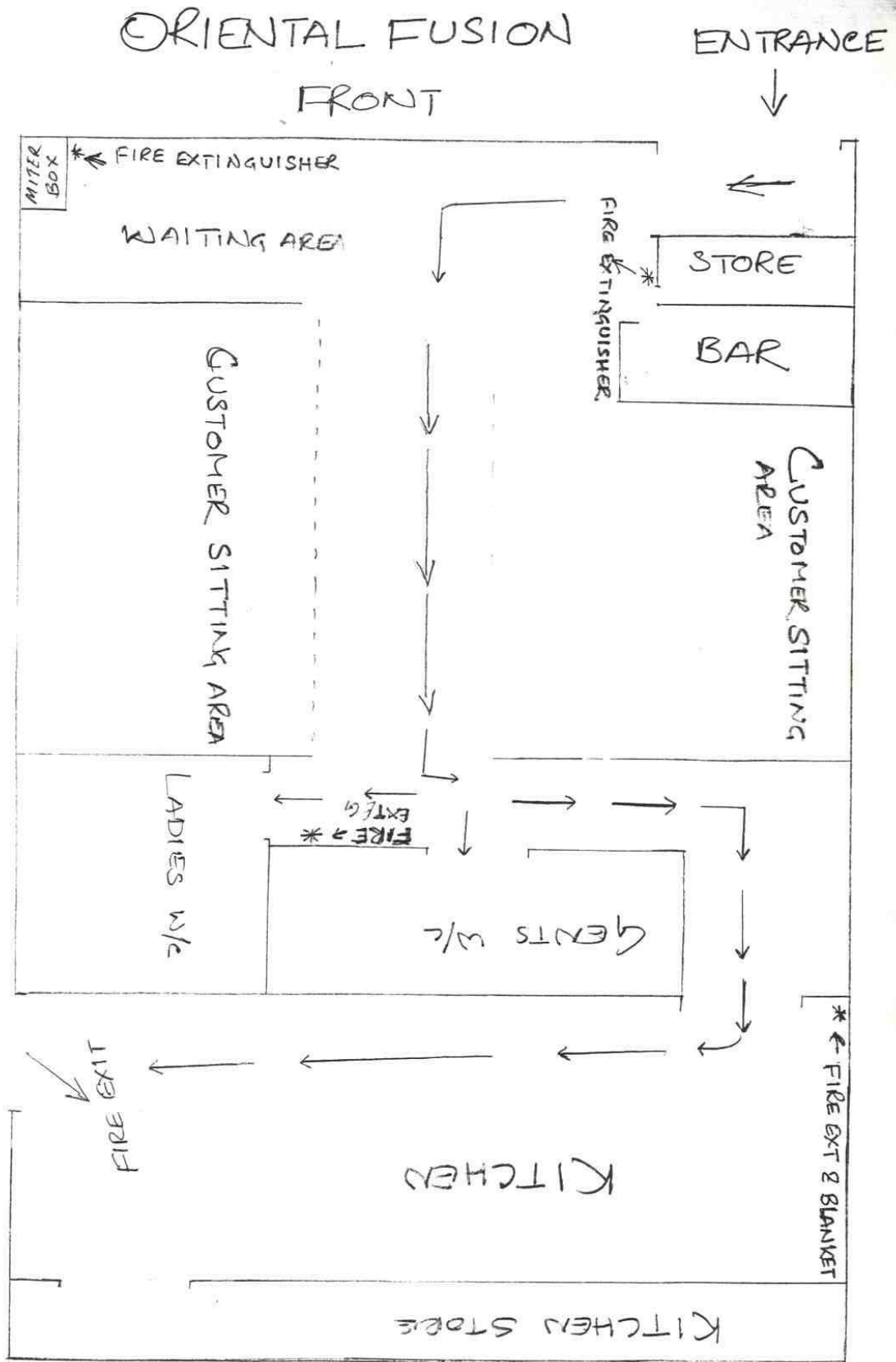

## **Annex 1 – Mandatory Conditions**

### **Mandatory conditions where the licence authorises the sale of alcohol (Note: Conditions 4, 5, and 7 relate to on-sales only)**

**These Mandatory Conditions form part of the Operating Schedule of your licence. You must ensure that the operation of the licensed premises complies with these Mandatory Conditions, as well as the Conditions stated in Annex 2 and Annex 3 (if applicable). Failure to do this can lead to prosecution or review of the licence.**

1. No supply of alcohol may be made at a time when there is no designated premises supervisor in respect of this licence.
2. No supply of alcohol may be made at a time when the designated premises supervisor does not hold a personal licence or the personal licence is suspended.
3. Every supply of alcohol under this licence must be made or authorised by a person who holds a personal licence.
4. (1) The responsible person must ensure that staff on relevant premises do not carry out, arrange or participate in any irresponsible promotions in relation to the premises.  
(2) In this paragraph, an irresponsible promotion means any one or more of the following activities, or substantially similar activities, carried on for the purpose of encouraging the sale or supply of alcohol for consumption on the premises
  - (a) games or other activities which require or encourage, or are designed to require or encourage, individuals to:
    - (i) drink a quantity of alcohol within a time limit (other than to drink alcohol sold or supplied on the premises before the cessation of the period in which the responsible person is authorised to sell or supply alcohol), or
    - (ii) drink as much alcohol as possible (whether within a time limit or otherwise);
  - (b) provision of unlimited or unspecified quantities of alcohol free or for a fixed or discounted fee to the public or to a group defined by a particular characteristic in a manner which carries a significant risk of undermining a licensing objective;
  - (c) provision of free or discounted alcohol or any other thing as a prize to encourage or reward the purchase and consumption of alcohol over a period of 24 hours or less in a manner which carries a significant risk of undermining a licensing objective;
  - (d) selling or supplying alcohol in association with promotional posters or flyers on, or in the vicinity of, the premises which can reasonably be considered to condone, encourage or glamorise anti-social behaviour or to refer to the effects of drunkenness in any favourable manner;
  - (e) dispensing alcohol directly by one person into the mouth of another (other than where that other person is unable to drink without assistance by reason of a disability).
5. The responsible person must ensure that free potable water is provided on request to customers where it is reasonably available.
6. (1) The premises licence holder or club premises certificate holder must ensure that an age verification policy is adopted in respect of the premises in relation to the sale or supply of alcohol.

(2) The designated premises supervisor in relation to the premises licence must ensure that the supply of alcohol at the premises is carried on in accordance with the age verification policy.

(3) The policy must require individuals who appear to the responsible person to be under 18 years of age (or such older age as may be specified in the policy) to produce on request, before being served alcohol, identification bearing their photograph, date of birth and either -

- (a) a holographic mark, or
- (b) an ultraviolet feature.

7. The responsible person must ensure that –

(a) where any of the following alcoholic drinks is sold or supplied for consumption on the premises (other than alcoholic drinks sold or supplied having been made up in advance ready for sale or supply in a securely closed container) it is available to customers in the following measures -

- (i) beer or cider: ½ pint;
- (ii) gin, rum, vodka or whisky: 25 ml or 35 ml; and
- (iii) still wine in a glass: 125 ml;

(b) these measures are displayed in a menu, price list or other printed material which is available to customers on the premises; and

(c) where a customer does not in relation to a sale of alcohol specify the quantity of alcohol to be sold, the customer is made aware that these measures are available.

A responsible person in relation to a licensed premises means the holder of the premises licence in respect of the premises, the designated premises supervisor (if any) or any individual aged 18 or over who is authorised by either the licence holder or designated premises supervisor. For premises with a club premises certificate, any member or officer of the club present on the premises in a capacity that which enables him to prevent the supply of alcohol.

8 (i) A relevant person shall ensure that no alcohol is sold or supplied for consumption on or off the premises for a price which is less than the permitted price.

(ii) For the purposes of the condition set out in paragraph 8(i) above -

(a) "duty" is to be construed in accordance with the Alcoholic Liquor Duties Act 1979;

(b) "permitted price" is the price found by applying the formula -

$$P = D + (D \times V)$$

Where -

(i) P is the permitted price,

(ii) D is the amount of duty chargeable in relation to the alcohol as if the duty were charged on the date of the sale or supply of the alcohol, and

(iii) V is the rate of value added tax chargeable in relation to the alcohol as if the value added tax were charged on the date of the sale or supply of the alcohol;

(c) "relevant person" means, in relation to premises in respect of which there is in force a premises licence -

(i) the holder of the premises licence,

(ii) the designated premises supervisor (if any) in respect of such a licence, or

(iii) the personal licence holder who makes or authorises a supply of alcohol under such a licence;

(d) "relevant person" means, in relation to premises in respect of which there is in force a club premises certificate, any member or officer of the club present on the premises in a capacity which enables the member or officer to prevent the supply in question; and

(e) "value added tax" means value added tax charged in accordance with the Value Added Tax Act 1994.

(iii). Where the permitted price given by Paragraph 8(ii)(b) above would (apart from this paragraph) not be a whole number of pennies, the price given by that sub-paragraph shall be taken to be the price actually given by that sub-paragraph rounded up to the nearest penny.

(iv). (1) Sub-paragraph 8(iv)(2) below applies where the permitted price given by Paragraph 8(ii)(b) above on a day ("the first day") would be different from the permitted price on the next day ("the second day") as a result of a change to the rate of duty or value added tax.

(2) The permitted price which would apply on the first day applies to sales or supplies of alcohol which take place before the expiry of the period of 14 days beginning on the second day.

### **Supply of alcohol under a Club Premises Certificate**

The mandatory conditions 4 to 8 above will apply. If the club premises certificate authorises the supply of alcohol for consumption off the premises, the following three mandatory conditions must also be included:

1. The supply of alcohol for consumption off the premises must be made at a time when the premises are open for the purposes of supplying alcohol to members of the club for consumption on the premises.
2. Any alcohol supplied for consumption off the premises must be in a sealed container.
3. Any alcohol supplied for consumption off the premises must be made to a member of the club in person.

### **Supply of alcohol from community premises**

The following mandatory condition will replace the first three mandatory conditions above when an application is made for a premises licence by the management committee of community premises and the licensing authority also grants an application for this alternative licence condition to be included in the licence:

1. Every supply of alcohol under the premises licence must be made or authorised by the [management committee / management board / board of trustees].

### **Mandatory condition when a premises licence or a club premises certificate authorises the exhibition of films**

9. Admission of children to the premises must be restricted in accordance with the film classification recommended by the British Board of Film Classification or recommended by this licensing authority as appropriate.

### **Mandatory Condition relating to door supervision which only applies where a premises licence includes a condition that one or more individuals must be at the premises to carry out a security activity**

10. All persons guarding premises against unauthorised access or occupation or against outbreaks of disorder or against damage (door supervisors) must be licensed by the Security Industry Authority.